

Mawson Park

Landscape Master Plan

Proposed Irrigation Works



Have your say on the proposed irrigation works for Mawson Park, Hillarys



Background — City of Joondalup Landscape Master Plan 2009–2019:

The City of Joondalup is currently facing restrictions on groundwater usage imposed by the State Government. These restrictions require all local governments to reduce their current rates of water consumption. In response to this direction, the City developed a Landscape Master Plan in 2009 to provide a strategic approach to infrastructure renewal and management programs, with the aim of reducing groundwater usage and improving irrigation efficiencies in landscaped areas.

Through this Plan, Mawson Park has been identified for irrigation upgrades and the City is proposing to take this opportunity to further improve the efficiency of the Park's watering regime by applying "hydrozoning" and "ecozoning" principles.

Identified issues in Mawson Park:

The City has identified the following issues present at Mawson Park (refer to the draft Concept Plan for locations):

1. Ageing irrigation infrastructure which has led to excessive water consumption.
2. Ageing play equipment at Playgrounds 1, 2, 4, 5 and 6 that does not meet current Australian Standards.
3. Low levels of vegetation surrounding the lake that affects the health of the water system.

Proposed works:

The City has developed a draft Concept Plan to address the above issues through the following means:

1. Replacement of all ageing irrigation infrastructure with new irrigation systems (including irrigation stations) that will allow for more efficient watering of the Park.
2. Zoning of the Park into four separate watering zones based on current levels of wear and tear and utilisation. (i.e. Applying "hydrozoning" and "ecozoning" principles).
3. Removal of ageing play equipment at Playgrounds 1, 2, 4, 5 and 6.
4. Landscaping of the area surrounding the lake, the island in the centre of the lake and the area surrounding the trees at the south-western end of the Park with low-lying shrubbery, groundcover plants and mulch.

The proposed works are shown in the draft Concept Plan opposite.

Draft Concept Plan

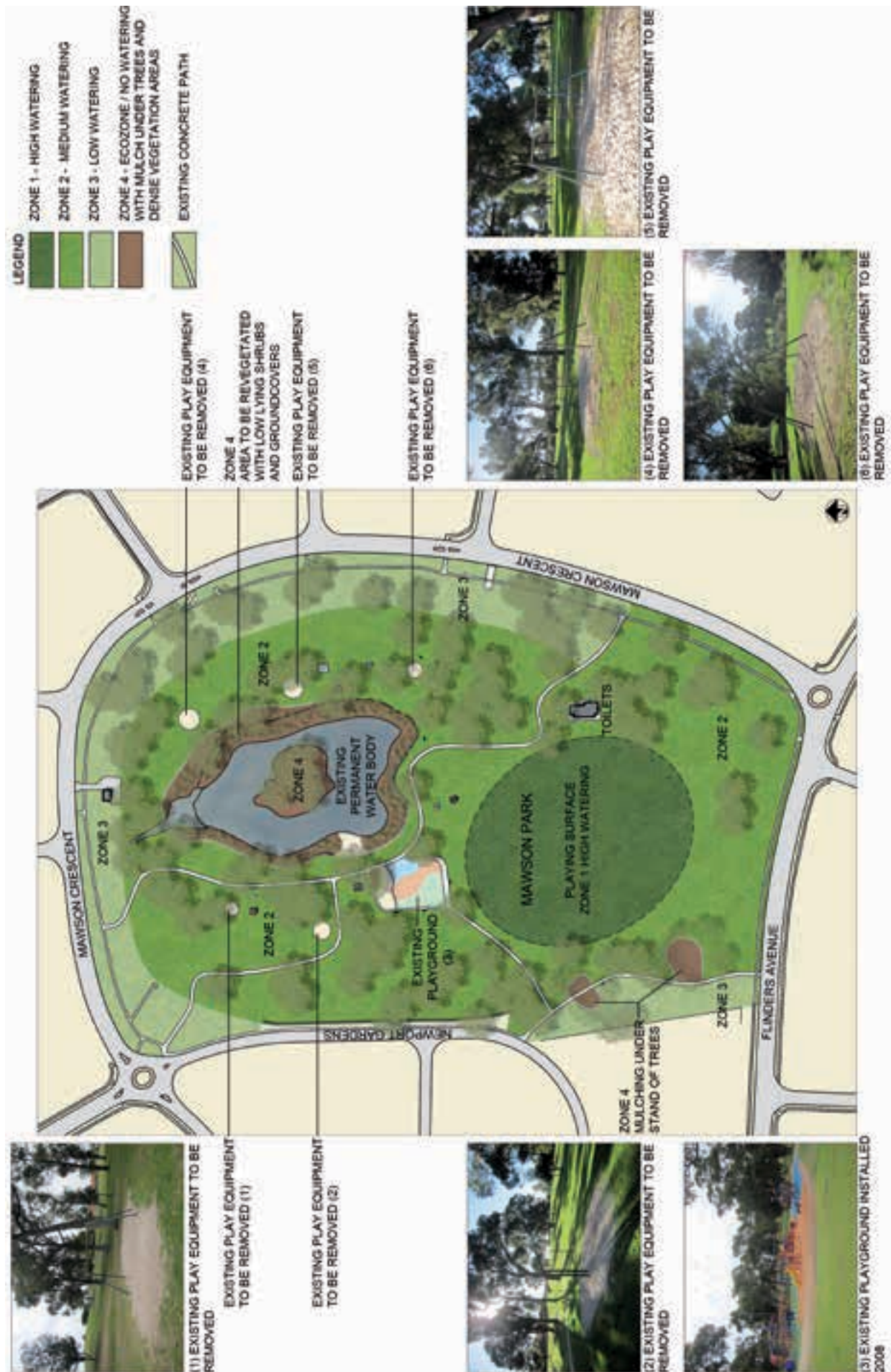



T: 08 9400 4000

F: 08 9300 1383

Boas Avenue Joondalup WA 6027

PO Box 21 Joondalup WA 6919

joondalup.wa.gov.au

This document is available in alternate formats upon request.