

STATED RESPONSE -

-  Inconvenienced by Closure
-  Not Inconvenienced by Closure

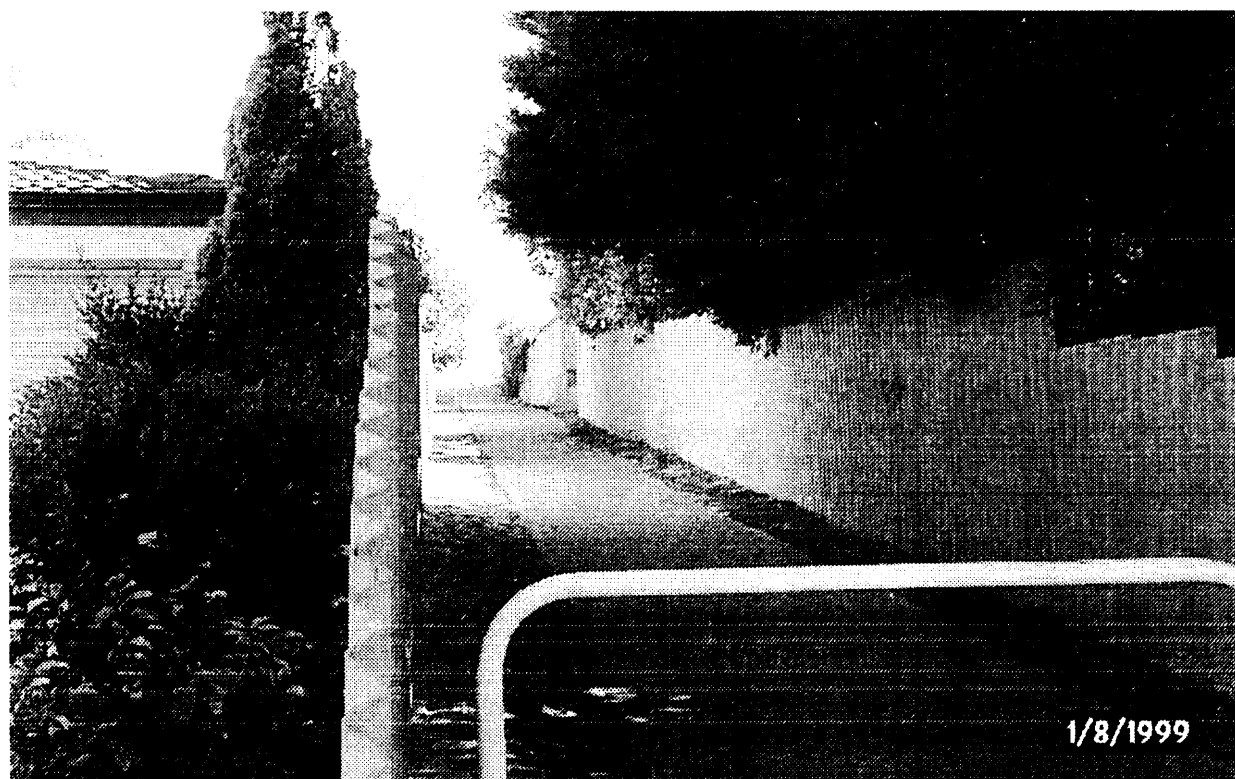



PEDESTRIAN ACCESSWAY BEGONIA STREET TO WARWICK ROAD, DUNCRAIG

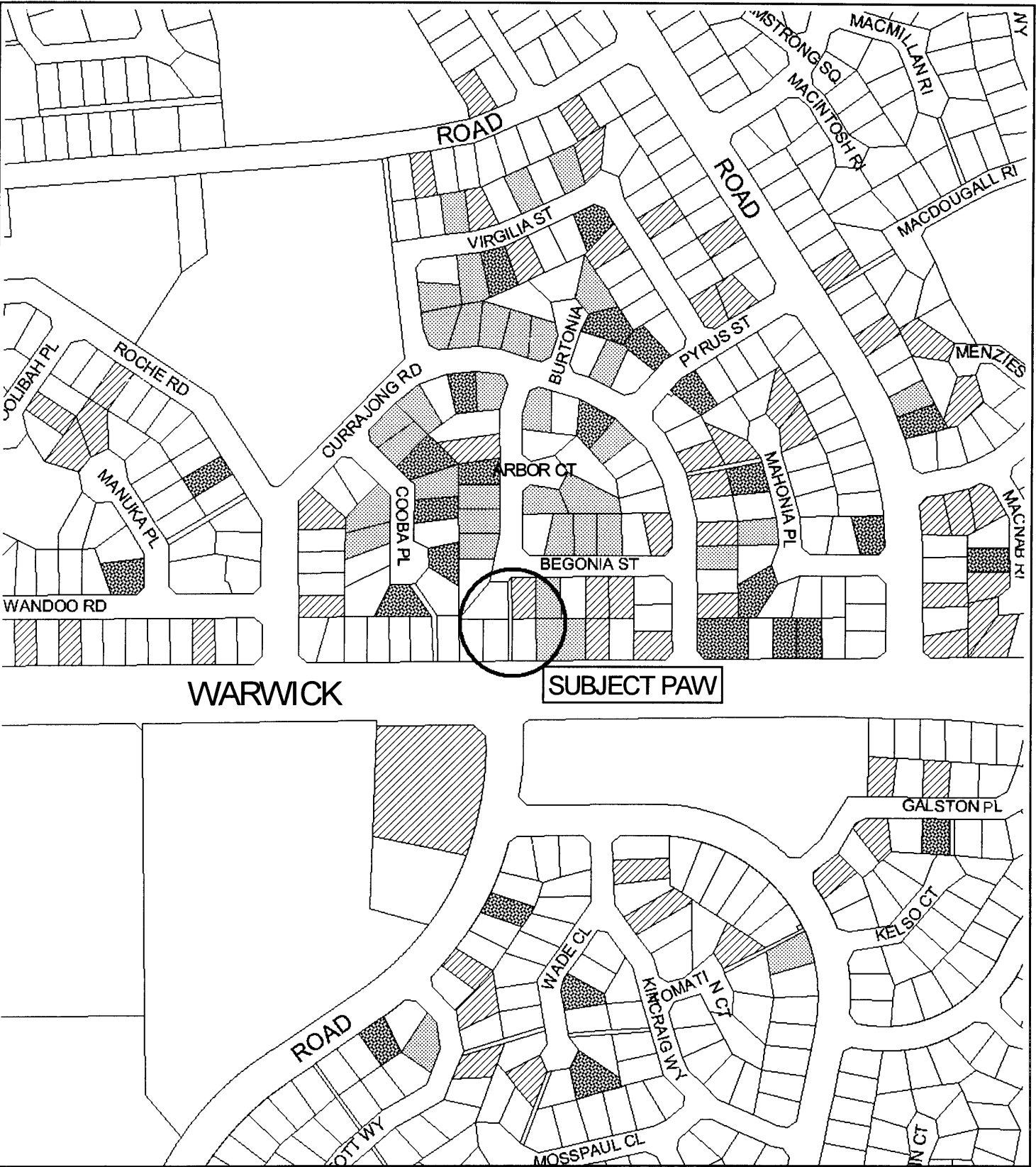

PEDESTRIAN ACCESSWAY WARWICK ROAD TO BEGONIA STREET, DUNCRAIG



-  Support for Closure
-  Closure Not Supported
-  Indifferent to Closure

**PEDESTRIAN ACCESSWAY CLOSURE BETWEEN BEGONIA STREET AND WARWICK ROAD
SCHEDULE OF SUBMISSIONS FOLLOWING ADVERTISING**

NO	NAME & ADDRESS OF SUBMITTOR	DESCRIPTION OF AFFECTED PROPERTY	SUBMISSION SUMMARY	COUNCIL'S RECOMMENDATION
1	M A Pearce 8 Currajong Road DUNCRAIG WA 6023	8 Currajong Road DUNCRAIG WA 6023	<p>Objects to closure. Provides the following points:</p> <ol style="list-style-type: none">1. Sympathetic to some of the anti-social behaviour experienced by residents abutting the PAW, however the PAW provides a service to pedestrians and cyclists and should remain open.2. Suggested improvements can be made to increase lighting and security patrols.	<ol style="list-style-type: none">1. Noted.2. Acknowledged. An opportunity exists for the PAW to be considered for a lighting trial as part of the City's Safer community Program subject to funds being available. Additional patrols may be requested.

NO	NAME & ADDRESS OF SUBMITTOR	DESCRIPTION OF AFFECTED PROPERTY	SUBMISSION SUMMARY	COUNCIL'S RECOMMENDATION
2	Mr T Jorgenson 6 Begonia Street DUNCRAIG WA 6023	6 Begonia Street DUNCRAIG WA 6023	<p>Objects to closure. Provides the following points:</p> <ol style="list-style-type: none"> 1. In response to concerns for child safety, the PAW provides a barrier to prevent runaway cyclists from crashing through to Warwick Road. Other streets such as Currajong Road do not have any barriers to prevent this from happening. Furthermore, responsible parents should not allow their children to play unsupervised in the street. 2. Graffiti is a minor problem. In all the time I have used the PAW I have not witnessed any acts of graffiti. No attempt has been made by abutting landowners to clean up the graffiti. 3. There is little evidence of vandalism along the PAW. There is more broken glass along Warwick Road. 4. Closure of the PAW may satisfy the 4 landowners abutting the PAW, but will inconvenience a greater number of households in the street. 	<ol style="list-style-type: none"> 1. Acknowledged. Whilst it is appreciated that some concern for child safety can be validated by having the PAW linked to the road, it is considered the risk would be similar to that expected for all housing in suburban area connected to the road system. 2. Noted. 3. Noted. 4. Noted.

NO	NAME & ADDRESS OF SUBMITTOR	DESCRIPTION OF AFFECTED PROPERTY	SUBMISSION SUMMARY	COUNCIL'S RECOMMENDATION
3	Mrs A Ellis 10 Cooba Place DUNCRAIG WA 6023	10 Cooba Place DUNCRAIG WA 6023	<p>Objects to closure. The following comments are made:</p> <ol style="list-style-type: none">Both the Cooba Place and Begonia Street PAW is used to obtain access to bus stops along Warwick Road.I occasionally visit the Begonia Street PAW and there is little evidence of damage to the adjoining properties or graffiti.PAW is important to enable easier pedestrian movement in suburbs designed with cul-de-sacs.Closure of the PAW will be an inconvenience to users in Begonia Street who wish to access Percy Dolye Complex, tennis courts, library and aged persons facilities.	<ol style="list-style-type: none">Noted.Noted.Acknowledged.Noted.

NO	NAME & ADDRESS OF SUBMITTOR	DESCRIPTION OF AFFECTED PROPERTY	SUBMISSION SUMMARY	COUNCIL'S RECOMMENDATION
4	T Stevenson 8 Begonia Street DUNCRAIG WA 6023	8 Begonia Street DUNCRAIG WA 6023	<p>Objects to closure. The following comments are made:</p> <ol style="list-style-type: none">1. I use the PAW every day and see little evidence of anti-social behaviour. There are only three points of graffiti, which have been there for between 2-3 years. No evidence of drug use is evident only the occasional beer can.2. Issue of child safety is emotional blackmail. Children should be under parent's supervision.3. The most to gain from closure are adjoining landowners who obtain large land area, Council who obtain higher rates and discard responsibility for maintenance.4. Those who dis-benefit from the closure of the PAW are the community who is inconvenienced.	<ol style="list-style-type: none">1. Acknowledged.2. Noted.3. Noted.4. Noted.

NO	NAME & ADDRESS OF SUBMITTOR	DESCRIPTION OF AFFECTED PROPERTY	SUBMISSION SUMMARY	COUNCIL'S RECOMMENDATION
5	R and N Dhue 21 Begonia Street DUNCRAIG WA 6023	21 Begonia Street DUNCRAIG WA 6023	<p>Object to closure. The following comments are made:</p> <p>1. We use the PAW daily and have never witnessed any anti-social behaviour in the 5 years living in the street. Some graffiti is present but this has been there for several years.</p> <p>2. Rubbish present in the PAW is minimal and infrequent.</p> <p>3. Residents who bought properties abutting the PAW did so in the knowledge of the possible problems arising</p>	<p>1. Noted.</p> <p>2. Noted.</p> <p>3. Noted.</p>