

ZONE	NOTES
Z1	MULTI LEVEL CAR PARKING - 10 LEVELS, 850 CAR BAYS, BASEMENT LINK TO ZONE 2.
Z2	EDUCATION CENTRE - 2 TEACHING LEVELS, CAR PARKING TO GROUND AND LEVEL 1, 130 CAR BAYS, BASEMENT LINK TO ZONE 1.
Z3	WARD EXTENSION - 3 LEVELS TO INCLUDE SUPPORT AT GROUND LEVEL - 40 BEDS, NO PARKING.
Z4	PUBLIC HOSPITAL WARD - 2 LEVELS OF WARDS PLUS 2 BASEMENT LEVELS FOR 300 CARS. REQUIRES RELOCATION OF PUBLIC & PRIVATE PSYCHIATRIC HOSPITALS TO ZONE 6 OR OFF SITE.
Z5	2 LEVELS TO PROVIDE OPERATING THEATRES & DAY PROCEDURE EXPANSION PLUS LOADING DOCK SUPPORT. EXPANSION TO GROUND LEVEL, NO PARKING.
Z6	PROVIDE NEW 2 LEVEL PUBLIC & PRIVATE PSYCHIATRIC HOSPITALS PLUS BASEMENT PARKING FOR 150 CARS.
Z7	PRIVATE HOSPITAL - PROVIDE 2 LEVELS OF CLINICAL SPACE PLUS 2 BASEMENT LEVELS FOR PARKING, 450 CARS BETWEEN Z7 & Z8.
Z8	PRIVATE HOSPITAL - 3 LEVEL INPATIENT WARD EXTENSION PLUS 2 BASEMENT LEVELS PARKING, SEE Z7.
Z9	3 LEVEL MEDICAL CENTRE & COMMERCIAL EXPANSION WITH SUB-BASEMENT STORMWATER RETENTION, NO PARKING.
Z10	IMAGING EXPANSION - GROUND LEVEL, NO PARKING.
Z11	PARKING, RADIOLOGY DEPT. EXPANSION - GROUND LEVEL, NO PARKING.
Z12	POTENTIAL POST 2020 JOONDALUP HEALTH CAMPUS DEVELOPMENT ZONE, REQUIRES RELOCATION OF COMMUNITY HEALTH & DENTAL.
Z13	POTENTIAL POST 2020 SITE DEVELOPMENT ZONE WITH STORMWATER RETENTION AT BASEMENT.
NOTE	PARKING NUMBERS BASED ON CONSTRAINED DEMAND MODEL PROVIDING 2040 ON-SITE BAYS (SSM TRAFFIC & TRANSPORT ASSESSMENT SEPT 07)

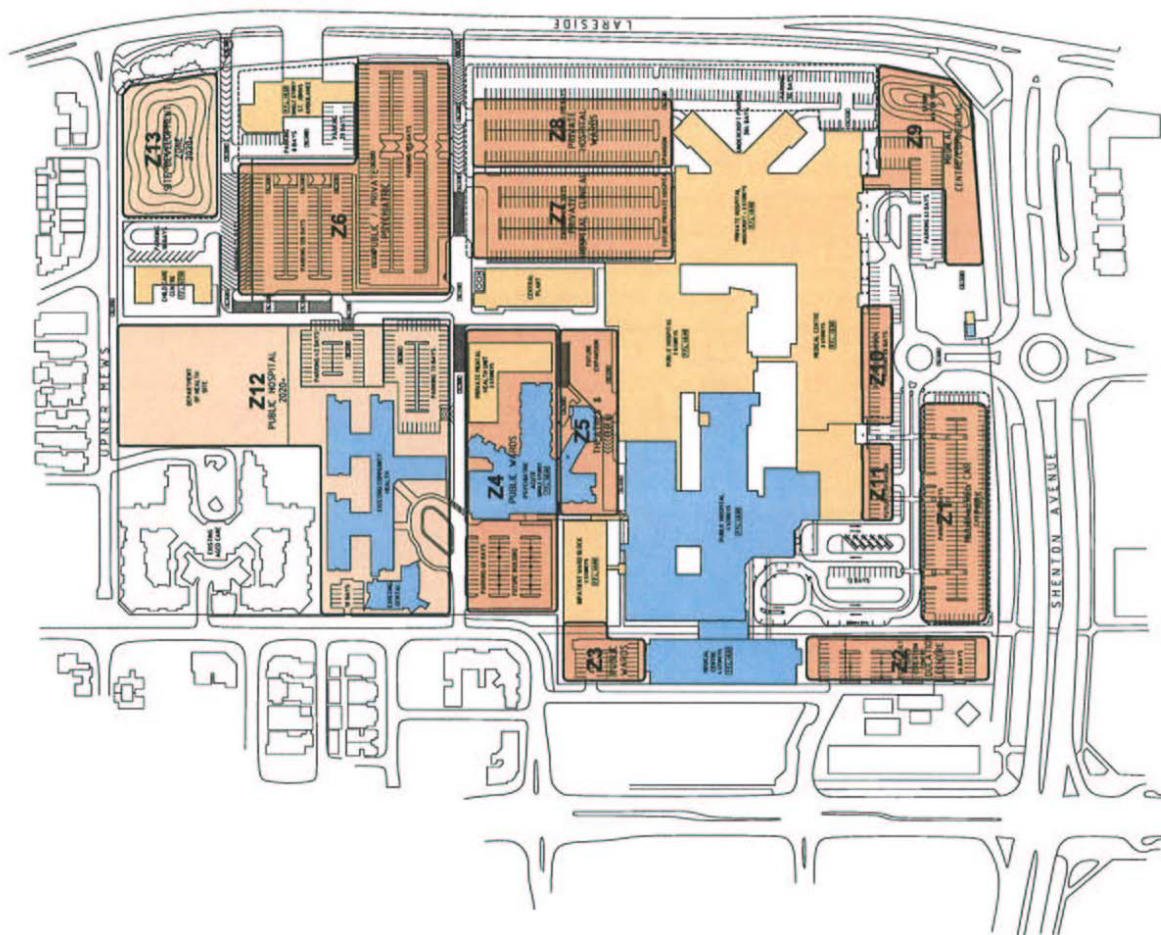

SITE PLAN - PROPOSED FUTURE DEVELOPMENT ZONE OPTIONS

SK 41

ARCHITECTS
HEALTH PLANNERS
INTERIOR DESIGNERS

NOV 2007

1:1000

JOONDALUP HEALTH CAMPUS
REDEVELOPMENT 2007 - STAGE 2

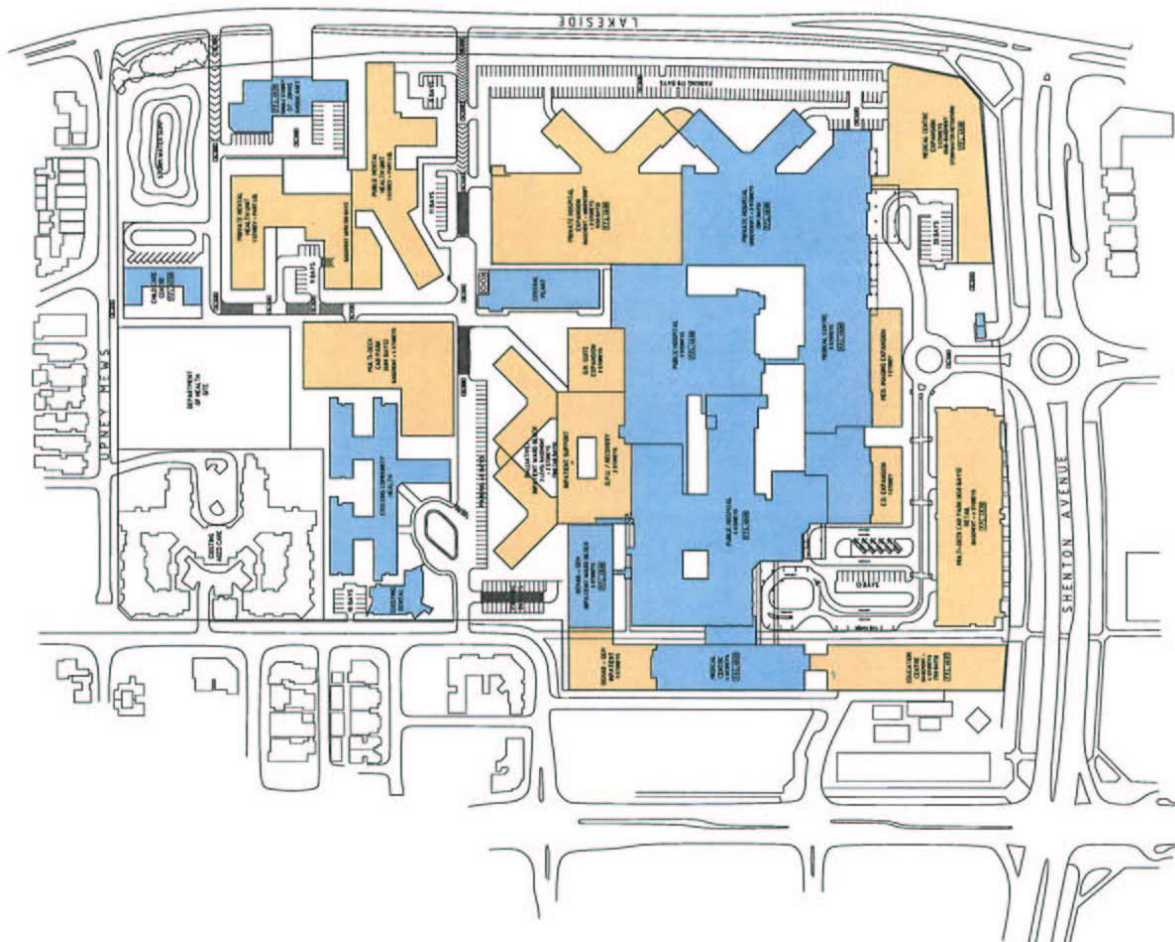

LEGEND
 EXISTING BUILDING
 PROPOSED EXPANSION



Department of Health
 Government of Western Australia

RAMSAY
 HEALTHCARE

Jondalup Health Campus
 Redevelopment 2007 - Stage 2

NOV 2007

1:1000

SITE PLAN - PROPOSED 2020 MASTERPLAN
 SK 42

ARCHITECTS
 HEALTH PLANNERS
 INTERIOR DESIGNERS
 peter hunt architect