

APPENDIX 2

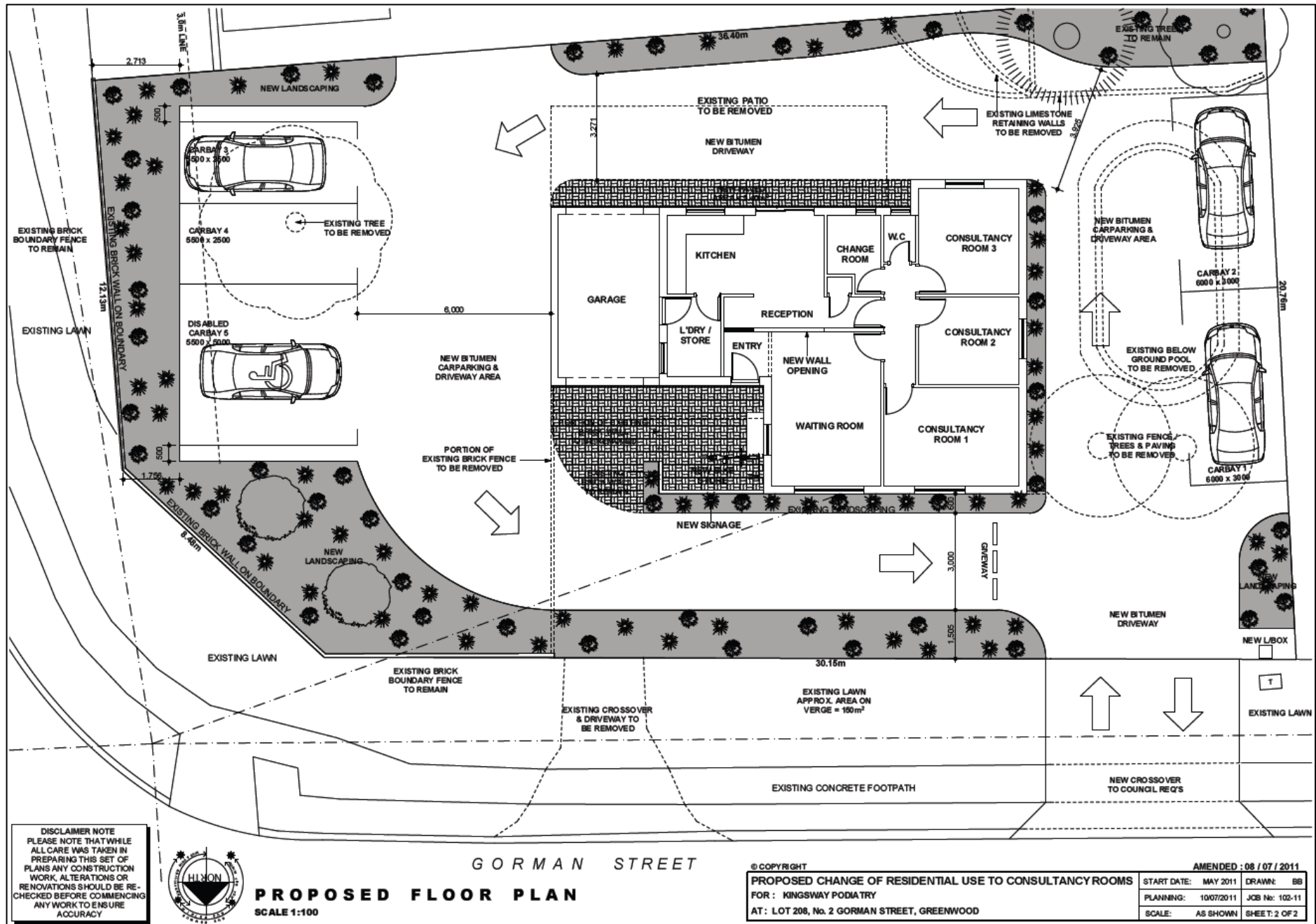







AREA : 680 m<sup>2</sup>  
LOT No: 208  
LOCATION  
REF (MSD)

**CARPARKING SETBACK VARIATION:**  
PLEASE NOTE THAT DUE TO THE MINIMUM REVERSING SETBACK OF 6.0m, FROM THE EXISTING GARAGE WALL, THE WANNEROO ROAD CARPARKING SETBACK ON THE SPALLED BOUNDARY LINE IS 2.713m & 1.756m RESPECTIVELY. WE ASK THIS TO BE TAKEN INTO ACCOUNT ALONG WITH THE EXISTING BRICK BOUNDARY WALL WHEN ASSESSING THESE AMENDED PLANS

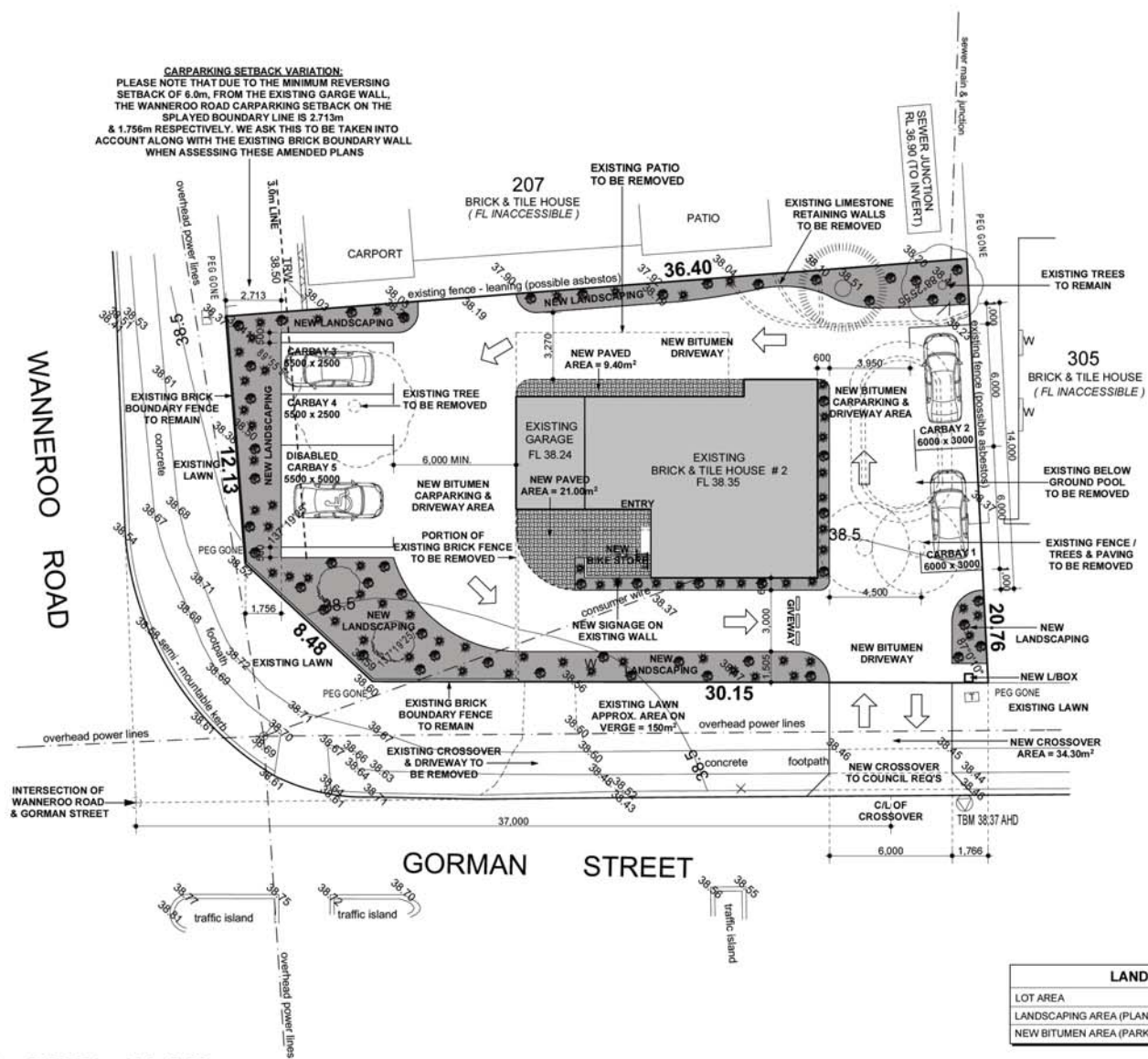

LANDSCAPING AREAS	
LOT AREA	680m <sup>2</sup>
LANDSCAPING AREA (PLANTS & MULCH)	144m <sup>2</sup> / 21.17%
NEW BITUMEN AREA (PARKING & DRIVEWAY)	391m <sup>2</sup>



**PROPOSED SITE PLAN**  
SCALE 1:200

© COPYRIGHT

**PROPOSED CHANGE OF RESIDENTIAL USE TO CONSULTANCY ROOMS**  
FOR : KINGSWAY PODIATRY  
AT : LOT 208, No. 2 GORMAN STREET, GREENWOOD

AMENDED : 08 / 07 / 2011

START DATE: MAY 2011	DRAWN: BB
PLANNING: 10/07/2011	JOB No: 102-11
SCALE: AS SHOWN	SHEET: 1 OF 2

